

## ADDENDUM #5

INVITATION TO BID  
Town of East Windsor  
Community Center Alterations and Additions  
28 Abbe Road  
East Windsor, Connecticut

1. **Confirm the mandatory pre-bid meeting held on 10-19-2023 was just for primes and not subcontractors. It was open to the public and anyone interested in bidding the work.**
2. **Provide back box type and cable needed for the T.V. Low profile 5x8 inch TV Box.**
3. **Provide length and description of the tape light in assembly room as it is not shown on the drawings or the fixture schedule. The led tape style light strips are set in a metal channel are installed along the top and width of the Existing Assembly room windows.**
4. **On Ground Floor Plan (A1), the only "1A" I have found is next to the door 134B. That number is the interior elevation view number nothing to do with partition. See Attachment.**
5. **Could you clarify which partitions are "1A"? Partition type 1A is not used.**

---

END OF ADDENDUM #5

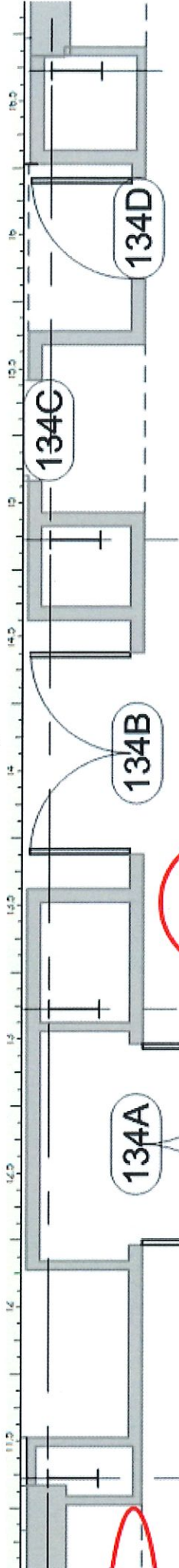

SOFFIT LINES  
ABOVE TYP.

**DRAWING**

# GROUND FLOOR PLAN

# A1

**EXISTING  
ASSEMBLY**

134



LETS



# PARTITION TYPES

- 1A** **ONE HOUR PARTITION - U.L. DESIGN NO. U305**  
3-5/8" 22 GA. CFMF @ 16" o/c W/ONE LAYER OF 5/8" TYPE 'X'  
GYPSUM BOARD EACH SIDE TO UNDERSIDE OF FLOOR/ROOF  
DECK. FIRE SEAL TOP OF PARTITIONS & ANY OPENINGS.
- 1B** 3-5/8" 22 GA. CFMF @ 16" o/c W/ONE LAYER OF 5/8"  
GYPSUM BOARD, ONE SIDE FULL HEIGHT.
- 1C** 3-5/8" 22 GA CFMF @ 16"o/c W/ONE LAYER OF 5/8" MOISTURE  
RESISTANT GYPSUM BOARD ONE SIDE ON RESTROOM SIDE  
FULL HEIGHT & ONE LAYER OF REGULAR 5/8" GYPSUM BOARD  
FULL HEIGHT.
- 1D** 3-5/8" 22 GA CFMF @ 16"o/c W/ONE LAYER OF 5/8" MOISTURE  
RESISTANT GYPSUM BOARD ONE SIDE FULL HEIGHT
- 1E** 3-5/8" 22 GA. CFMF @ 16" o/c W/ONE LAYER OF 5/8" STANDARD  
GYPSUM BOARD EACH SIDE FULL HEIGHT.
- 1H** **ONE HOUR PARTITION - U.L. DESIGN NO. U305**  
8" 22 GA. CFMF @ 16" o/c W/ONE LAYER OF 5/8" TYPE 'X'  
GYPSUM BOARD EACH SIDE TO UNDERSIDE OF FLOOR/ROOF  
DECK. FIRE SEAL TOP OF PARTITIONS & ANY OPENINGS.

DRAWING

## GROUND FLOOR PLAN

# A1